

CERTIFIED LAND CORNER RECORDATION

DESCRIPTION OF CORNER EVIDENCE FOUND, AND ORIGINAL RECORD (If known)

Found flat red sandstone rock with $\frac{1}{4}$ marked on top face.

DESCRIPTION OF MONUMENT AND ACCESSORIES ESTABLISHED
TO PERPETUATE THE ORIGINAL LOCATION OF THIS CORNER:

See sketch below.

SKETCH, WITH COURSE AND DISTANCE TO ADJACENT CORNER IF DETERMINED IN THIS SURVEY.
(May Sketch or Paste Reproduction on Reverse Side.)

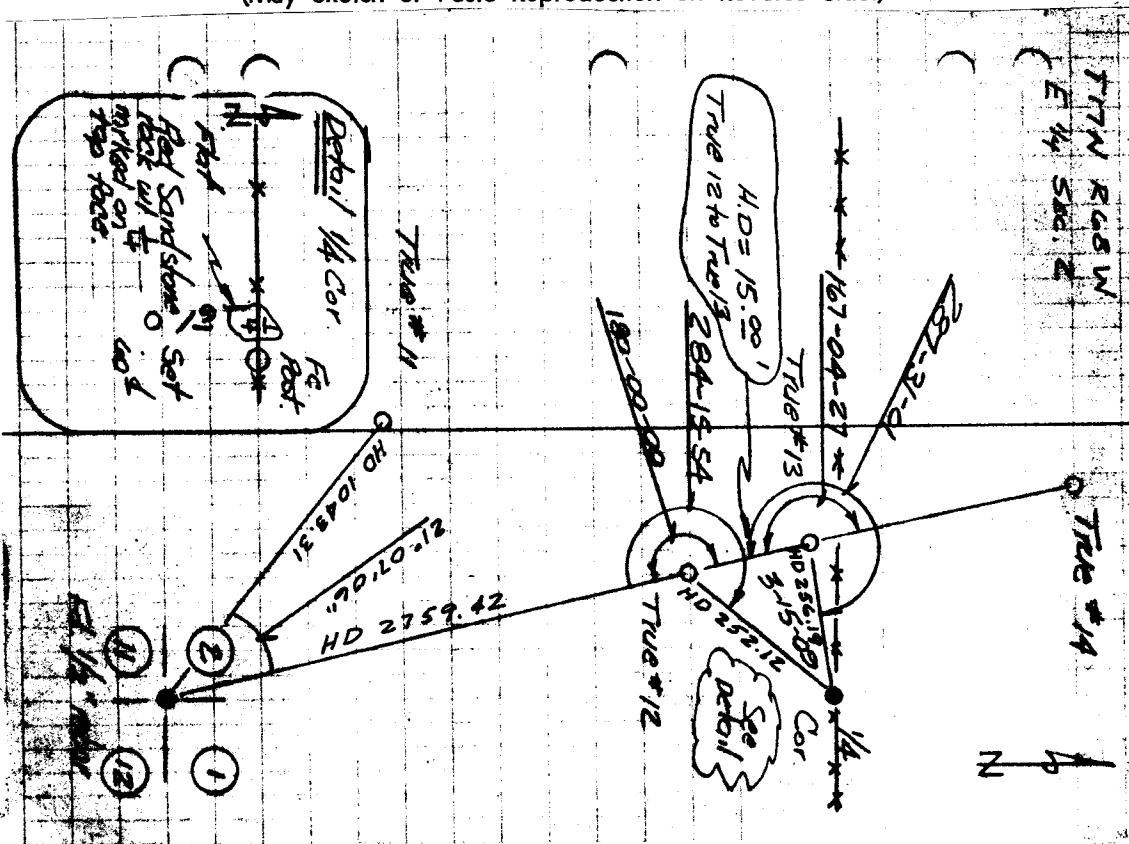

I, Albert L. Scott certify that I have carefully performed or reviewed the work done on the diagrammed corner as reported on this recordation form and approve the same.

Albert L. Scott
Signature of Surveyor

L.S. 2573
Registration No.

STATE OF WYOMING,
Office of Clerk and Recorder,
County of _____

567546

This "corner record" was filed for record on the _____ day of FEB 12 1900, 19____, was noted on the cross-index plat and is assigned page No. _____, in book No. _____.

James C. Whitehead

	County Official		
	21	17N	68W
Cross Index No.	T. _____	R. _____	6th P.M.
	T. _____	R. _____	Mer.
	T. _____	R. _____	Mer.
	T. _____	R. _____	Mer.
	T. _____	R. _____	Mer.
	T. _____	R. _____	Mer.
	T. _____	R. _____	Mer.